

Outline

Standard

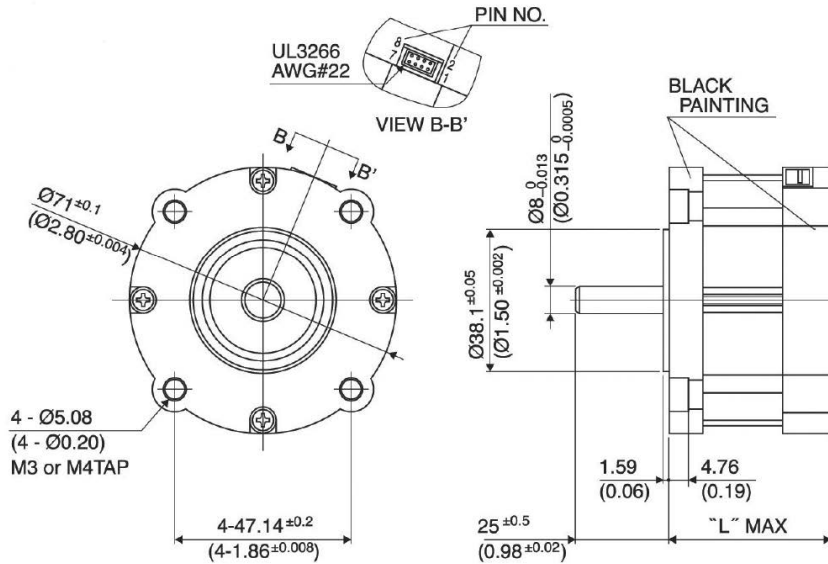

Hybrid



	"L"
29SM-K5XX	39.5 (1.56)
29SM-K2XX	43.5 (1.71)
29SM-K3XX	51.5 (2.03)
29SM-K0XX	55.5 (2.19)
29SM-K1XX	67.5 (2.66)
29SM-K7XX	77.5 (3.05)

Specifications

Model	Motor Size (mm)	Step Angle (deg)	Rated Current (A)	Resistance (Ohms)	Holding Torque (mNm)	Mass (g)
29SM-K550-00VS/99VS	71 ~ 39.5	1.8	1.5	2.1	380	570
29SM-K250-00VS/99VS	71 ~ 43.5	1.8	1.6	2	580	660
29SM-K379-00VS/99VS	71 ~ 51.5	1.8	1.9	1.75	820	820
29SM-K035-00VS/99VS	71 ~ 55.5	1.8	2.2	1.55	900	900
29SM-K138-00VS/99VS	71 ~ 67.5	1.8	2.6	1.25	1200	1180
29SM-K711-00VS/99VS	71 ~ 77.5	1.8	3.1	0.95	1550	1390

Torque/Speed Characteristics

Model No.: 29SM-K5XX, K2XX, K0XX, K1XX, K3XXU, K3XXB, K7XXU, K7XXB
 Driver: Chopper Dual
 Supply Voltage: 24 (volt)

