

Round 25 □ 1.8°

10GR

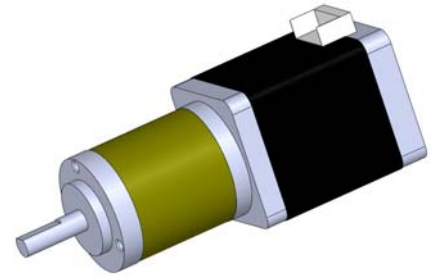
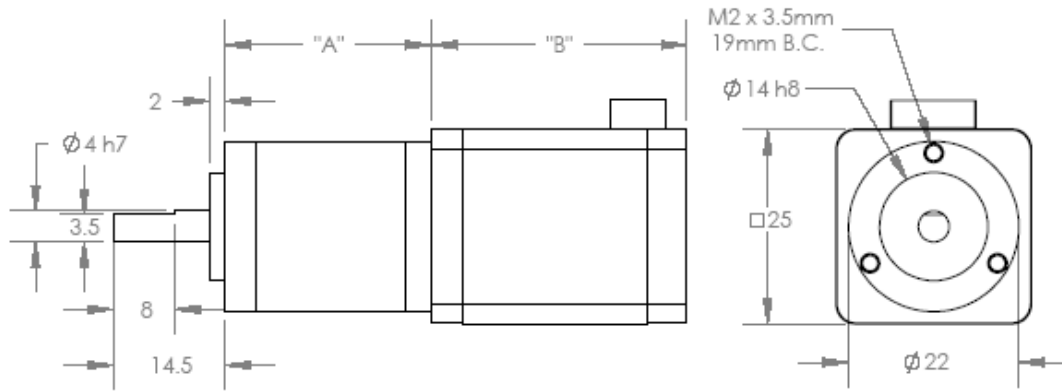

Standard Motor Lengths	
Type	"B" (mm)
10GR-K0	34
10GR-K4	48
10GR-K4L	60

(PHASE)	A	-B	-A	B
(PIN NO.)	4	1	6	3

Gearbox Ratio Selection

	Characteristics			
	26.6mm	34.8mm	43mm	51.5mm
Dimension "A"	26.6mm	34.8mm	43mm	51.5mm
Max Torque	0.2Nm	0.4Nm	0.6Nm	0.7Nm
GB Eff	88%	75%	70%	65%
Max Backlash	1.5 deg	2 deg	2.5 deg	3 deg
Max Radial Load	15N	30N	45N	60N
Max Axial Load	30N	30N	30N	30N
GB Weight	41g	52g	63g	74g

Available Ratios							
1 Stage		2 Stages		3 Stages		4 Stages	
XXX	Act	XXX	Act	XXX	Act	XXX	Act
3:1	(3.70)	14:1	(13.73)	51:1	(50.89)	189:1	(188.61)
4:1	(4.28)	16:1	(15.88)	59:1	(58.85)	218:1	(218.12)
5:1	(5.18)	18:1	(18.36)	68:1	(68.06)	252:1	(252.24)
7:1	(6.75)	19:1	(19.20)	71:1	(71.16)	264:1	(263.72)
		22:1	(22.20)	79:1	(78.71)	292:1	(291.71)
		25:1	(25.01)	93:1	(92.70)	305:1	(304.99)
		27:1	(26.85)	95:1	(95.17)	337:1	(337.35)
		29:1	(28.93)	100:1	(99.50)	344:1	(343.54)
		35:1	(34.97)	107:1	(107.20)	353:1	(352.71)
		46:1	(45.56)	115:1	(115.07)	369:1	(368.76)
				124:1	(123.97)	397:1	(397.29)
				130:1	(129.62)	408:1	(407.89)
				139:1	(139.13)	426:1	(426.46)
				150:1	(149.90)	459:1	(459.45)
				169:1	(168.84)	480:1	(480.36)
				181:1	(181.24)	493:1	(493.18)
				195:1	(195.26)	516:1	(515.62)
				236:1	(236.09)	531:1	(531.34)
				308:1	(307.54)	556:1	(555.52)
						596:1	(596.30)
						626:1	(625.73)
						642:1	(642.42)
						672:1	(671.67)
						721:1	(720.98)
						724:1	(723.63)
						777:1	(776.76)
						837:1	(836.86)
						875:1	(874.94)
						939:1	(939.18)
						1012:1	(1011.84)
						1140:1	(1139.73)
						1223:1	(1223.41)
						1318:1	(1318.05)
						1594:1	(1593.65)



Catalog Part Numbering

10GR - XX - XXXXX

↑ ↑ ↑
 Motor Length Ratio
 Spur
 Helical

Example:
 10GR-K0-S0079

10GR - 10 Size Round Gearbox Motor
K0 - 34 mm long stator
S079 - Spur Gearbox ratio of 79:1

Other Available Options:

- Encoders
- Pinions
- Drivers