

34GR

Round 85 1.8°

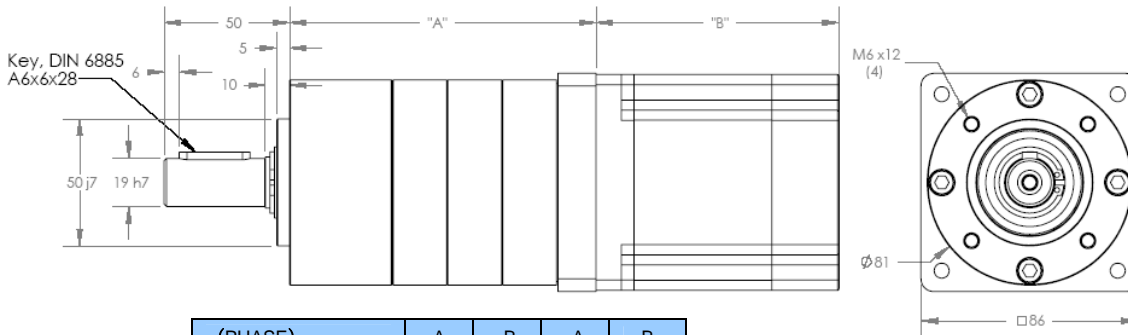
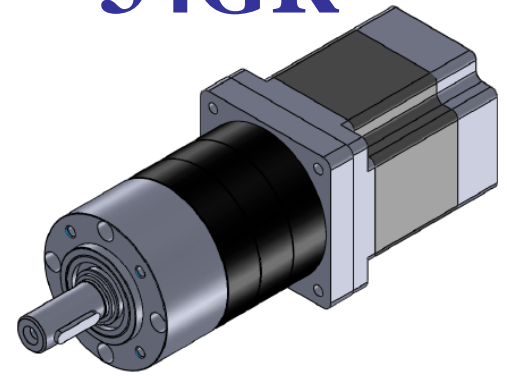

Standard Motor Lengths	
Type	"B" (mm)
34GR-K0	66
34GR-K1	96
34GR-K2	126

(PHASE)	A	-B	-A	B
(PIN NO.)	4	1	6	3

Gearbox Ratio Selection

Characteristics				
Dimension "A"	77.9mm	99.6mm	121.3mm	143mm
Max Torque	20 Nm	60 Nm	120 Nm	120 Nm
GB Eff	80%	75%	70%	65%
Max Backlash	0.50 Deg	0.55 Deg	0.60 Deg	0.65 Deg
Max Radial Load	400N	600N	1000N	1300N
Max Axial Load	80N	120N	200N	280N
GB Weight	1.8 kg	2.5 kg	3.2 kg	3.9 kg

Available Ratios									
1 Stage		2 Stages		3 Stages		4 Stages			
Spur	Helical	Spur	Helical	Spur	Helical	Spur	Helical	Spur	Helical
4:1 (3.70)	4:1 (3.65)	14:1 (13.73)	14:1 (13.53)	51:1 (50.89)	50:1 (50.16)	189:1 (188.61)	186:1 (185.88)		
4:1 (4.28)	5:1 (4.59)	16:1 (15.88)	16:1 (15.65)	59:1 (58.85)	58:1 (58.01)	218:1 (218.12)	215:1 (214.96)		
5:1 (5.18)	5:1 (5.36)	18:1 (18.36)	18:1 (17.01)	68:1 (68.06)	67:1 (67.08)	252:1 (252.24)	249:1 (248.59)		
7:1 (6.75)	7:1 (6.55)	19:1 (19.20)	19:1 (18.92)	71:1 (71.16)	70:1 (70.13)	264:1 (263.72)	260:1 (259.91)		
	9:1 (8.63)	22:1 (22.20)	22:1 (22.96)	79:1 (78.71)	81:1 (81.11)	292:1 (291.71)	287:1 (287.49)		
		25:1 (25.01)	25:1 (24.65)	93:1 (92.70)	91:1 (91.36)	305:1 (304.99)	301:1 (300.57)		
		27:1 (26.85)	27:1 (27.76)	95:1 (95.17)	98:1 (98.07)	337:1 (337.35)	339:1 (338.56)		
		29:1 (28.93)	29:1 (28.05)	100:1 (99.50)	101:1 (101.89)	344:1 (343.54)	348:1 (347.60)		
		35:1 (34.97)	35:1 (33.92)	107:1 (107.20)	106:1 (105.65)	353:1 (352.71)	361:1 (361.17)		
		46:1 (45.56)	46:1 (44.69)	115:1 (115.07)	115:1 (114.77)	369:1 (368.76)	365:1 (364.66)		
			58:1 (58.22)	124:1 (123.97)	123:1 (123.20)	397:1 (397.29)	392:1 (391.53)		
				130:1 (129.62)	128:1 (127.74)	408:1 (407.89)	420:1 (420.28)		
				139:1 (139.13)	137:1 (136.99)	426:1 (426.46)	425:1 (425.34)		
				150:1 (149.90)	145:1 (145.36)	459:1 (459.45)	457:1 (456.56)		
				169:1 (168.84)	166:1 (166.40)	480:1 (480.36)	473:1 (473.40)		
				181:1 (181.24)	176:1 (175.75)	493:1 (493.18)	492:1 (491.89)		
				195:1 (195.26)	192:1 (191.54)	516:1 (515.62)	515:1 (515.24)		
				236:1 (236.09)	232:1 (231.59)	531:1 (531.34)	533:1 (533.08)		
				308:1 (307.54)	302:1 (301.68)	556:1 (555.52)	547:1 (547.47)		
					393:1 (392.98)	596:1 (596.30)	595:1 (594.73)"		
						626:1 (625.73)	623:1 (622.97)		
						642:1 (642.42)	638:1 (638.40)		
						672:1 (671.67)	679:1 (678.94)		
						721:1 (720.98)	713:1 (713.15)		
						724:1 (723.63)	745:1 (745.38)		
						777:1 (776.76)	775:1 (774.72)		
						837:1 (836.86)	832:1 (831.60)		
						875:1 (874.94)	862:1 (862.27)		
						939:1 (939.18)	925:1 (924.65)		
						1012:1 (1011.84)	1046:1 (1046.08)		
						1140:1 (1139.73)	1123:1 (1123.21)		
						1223:1 (1223.41)	1200:1 (1200.07)		
						1318:1 (1318.05)	1393:1 (1292.91)		
						1594:1 (1593.65)	1563:1 (1563.24)		



Catalog Part Numbering

34GR - XXX - XXXXX

Step Option

'B' Motor Length

S Spur
H Helical

'XXXX' Ratio

Step Options:
B - 1.8 Degree

Other Available Options:

- Encoders
- Pinions
- Drivers

Example:

34GR-BK0-S0079

34GR - 34 Size Round Gearbox Motor
BK0 - 1.8 Degree, 66 mm long stator
S0079 - Spur Gearbox ratio of 79:1