

BLDC15

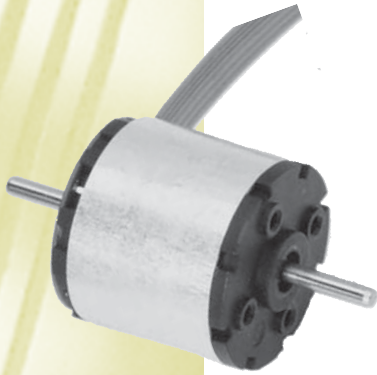
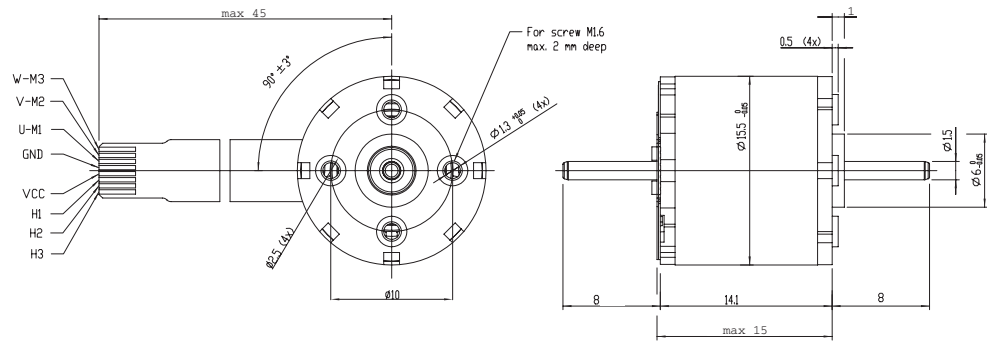

General Specification

Insulation class F
 Housing protection IP30
 Operating temperature $-0^{\circ}\text{C} \dots +45^{\circ}\text{C}$
 2 NMB ballbearings for long lifetime
 Max. radial load 2 N (5mm from flange)
 Max. axial load 2 N

Features

Excellent power to volume ratio
 High efficiency at operating point
 High reliability

Options

Without rear shaft

NMB-Partnumber		BLDC15P06-6V	BLDC15P06-12V
		43.1.0106	43.1.0106
Rated Voltage	[V]	6	12
Rated Speed	[rpm]	3600	10000
Continuous Power	[W]	0.84	2
Rated Torque	[mNm]	2.2	1.91
Continous Stall Torque	[mNm]	2.8	2.8
Efficiency at Rated Speed	[%]	54.2	70
Current at Rated Speed	[A]	0.255	0.23
No Load Speed	[rpm]	6500	12900
Resistance per Phase *1)	[Ω]	9.8	9.8
Inductance per Phase	[mH]	0.51	0.51
Torque Constant	[mNm/A]	8.8	8.3
Speed Constant	[rpm/V]	1085	1075
Mech. Time Constant	[ms]	10.1	10.1
Rotor Inertia	[gcm ²]	0.8	0.8
Number of Poles		12	12
Weight	[g]	15	15
Thermal Resistance *2)	[K/W]	40	40

Dwg.No.: 120701200025C

*1) resistance phase to phase at 20°C

*2) thermal resistance winding to ambient