



PM Motor
PM Type

Reference Characteristics

Motor Size	PM25S-024
Number of Steps per Rotation	24(15°/Step)
Drive Method	2-2 PHASE
Drive Circuit	UNIPOLAR CONST. VOLT.
Drive Voltage	24[V]
Current/Phase	
Coil Resistance/Phase	70[Ω]
Drive IC	2SC3346
Magnet Material	Polar anisotropy ferrite sintered magnet (MS50) Nd-Fe-B bonded magnet (MS70)
Insulation Resistance	100M[Ω] MIN
Dielectric Strength	AC 500[V] 1[min]
Class of Insulation	CLASS E
Operating Temp.	-10[°C] ~ 50[°C]
Storage Temp.	-30[°C] ~ 80[°C]
Operating Hum.	20[%] RH ~ 90[%] RH

Applications

- OA Equipment : Printers / Scanners
- Automotive : Meters
- Home electric appliances : Gas range
- Home automation appliances : Sewing machines

Torque Characteristics

PM25S-024 UNI-CONST. V (at 24[V],70[Ω])

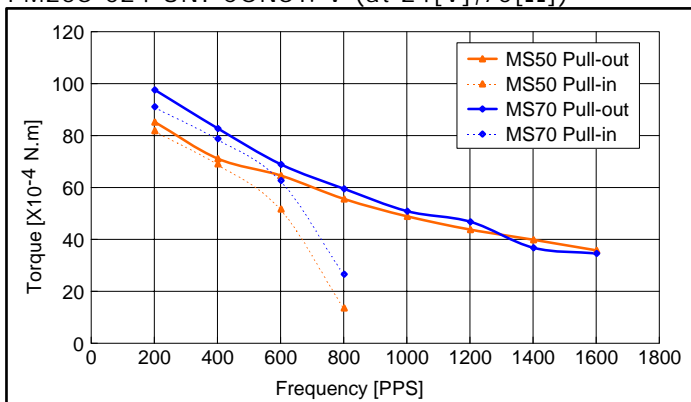

These torque values are reference only. Heat radiation conditions and temperature rise effect by duty are different on each equipment, therefore please select motors after considering the heat conditions in the actual equipment.

Dimensions

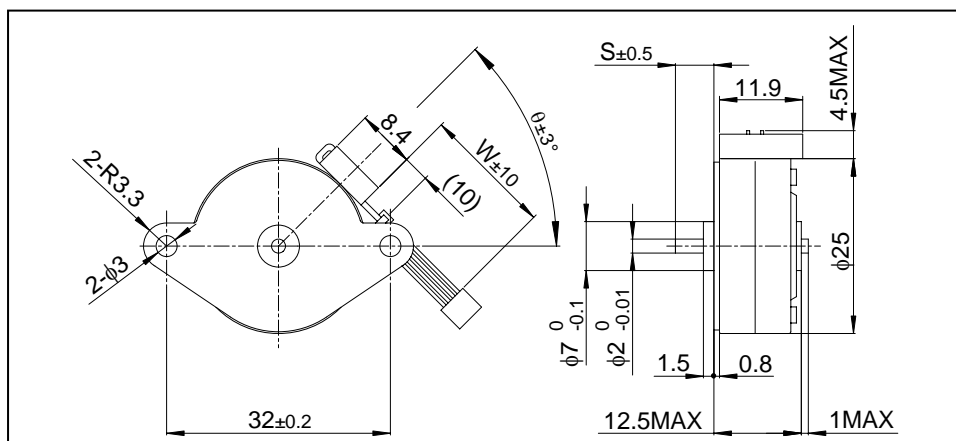

If you would like to know this Dimensions(D,S,W,θ), Please see Standard Dimensions in our Home Page.