

SE15H

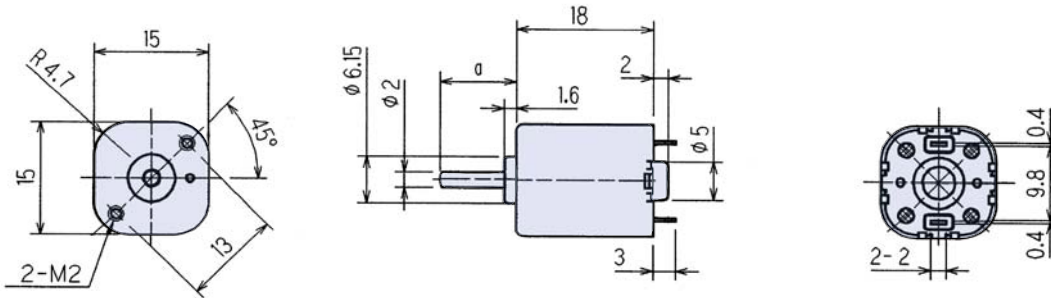

Weight: 13.5 g

Outline UNIT:mm



Specifications

Model	Operating Voltage (V)	Rated Voltage (V)	No Load Speed (min ⁻¹)	No Load Current (mA)	Rated Load		Rated Load Speed (min ⁻¹)	Rated Load Current (mA)	Starting Torque		Starting Current (mA)	Shaft Length (mm)
					(gf·cm)	(mN·m)			(gf·cm)	(mN·m)		
SE15H0VTM	8 to 13	12.0	8403	76	20.4	2.0	6583	240	94.2	9.2	834	a=14.8
SE15H1BTM	8 to 13	12.0	11962	99	20.4	2.0	10021	325	125.8	12.3	1496	a=14.8

Characteristics

