

Detach Connectors

CAM-J09, CAM-J10

FEATURES

1. A 32-pole Connector that is used for connection/disconnection between the operating panel and a unit.
2. The deviation absorption amount at fitting is $\pm 0.5\text{mm}$ in the X direction, $\pm 0.2\text{mm}$ in the Y direction, and $+0.7\text{mm}$, -0.5mm in the Z direction.
3. At pulling out, the connector is pushed out by light repulsive power.
4. This connector is surely fixed by the attached lock pin after a board is inserted.

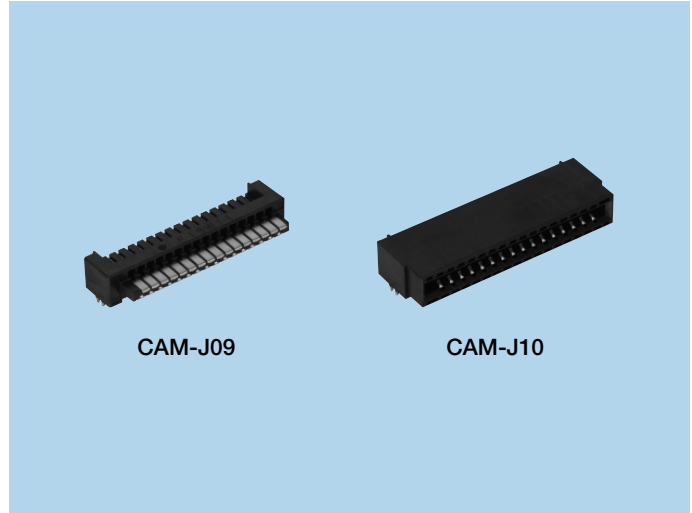

CAM-J09

CAM-J10

HOW TO ORDER

1. CAM-J09

J09 - 032 - 210 - AGBAB
 1 2

1 Series No. (J09)

2 No. of contacts (032 : 32pins)

2. CAM-J10

J10 - 032 - 210 - AGBAB
 1 2

1 Series No. (J10)

2 No. of contacts (032 : 32pins)

SPECIFICATIONS

ELECTRICAL CHARACTERISTICS

Rated Voltage	14V DC
Rated Current	1A
Withstanding Voltage	500V AC (rms) 1minute
Insulation Resistance	500MΩ min. (500V DC)
Contact Resistance	100mΩ max.

MECHANICAL CHARACTERISTICS

Life (Matching Cycle)	10,000 times
Total Insertion Force	18.0N max.
Total Withdrawal Force	3.5N max.
Using Temperature Range	-30~+85°C

MATERIAL & FINISH

Component Parts		Material	Finish
CAM-J09	Housing	LCP resin	(Black)
	Contact Pin	Copper alloy	Gold plating
	Lock Pin	Copper alloy	Tin reflow plating
CAM-J10	Housing	LCP resin	(Black)
	Contact Pin	Copper alloy	Gold plating
	Lock Pin	Copper alloy	Tin reflow plating

DIMENSIONS

CAM-J09

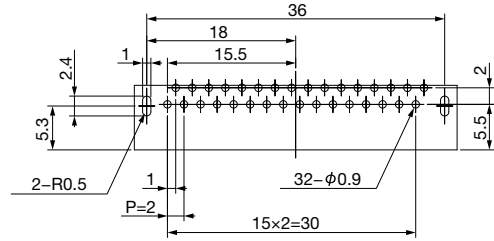
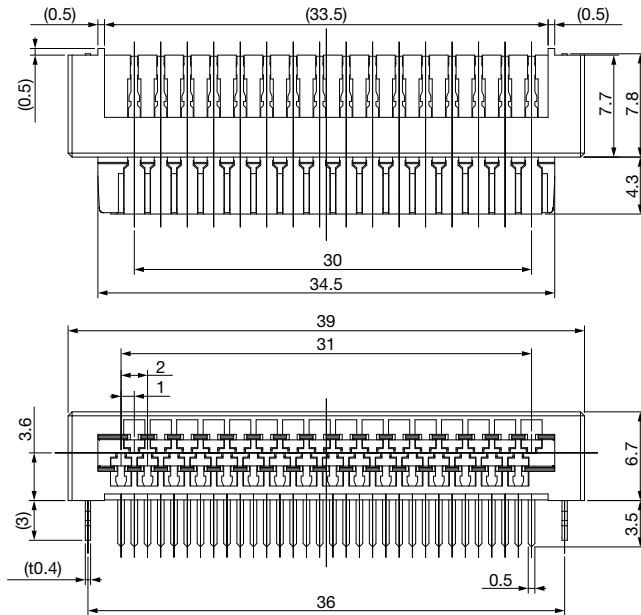

The reference PWB size. (t1.6) TOLERANCE:±0.05

NOTES

- 1) This connector supports flow. (The reflow does not support.)
- 2) Conformity PWB thickness : t=1.6mm, 1.2mm.

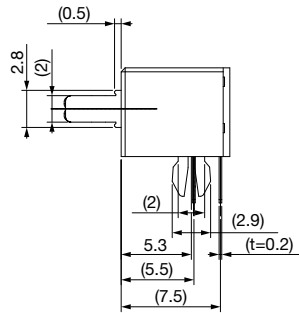

CAM-J10

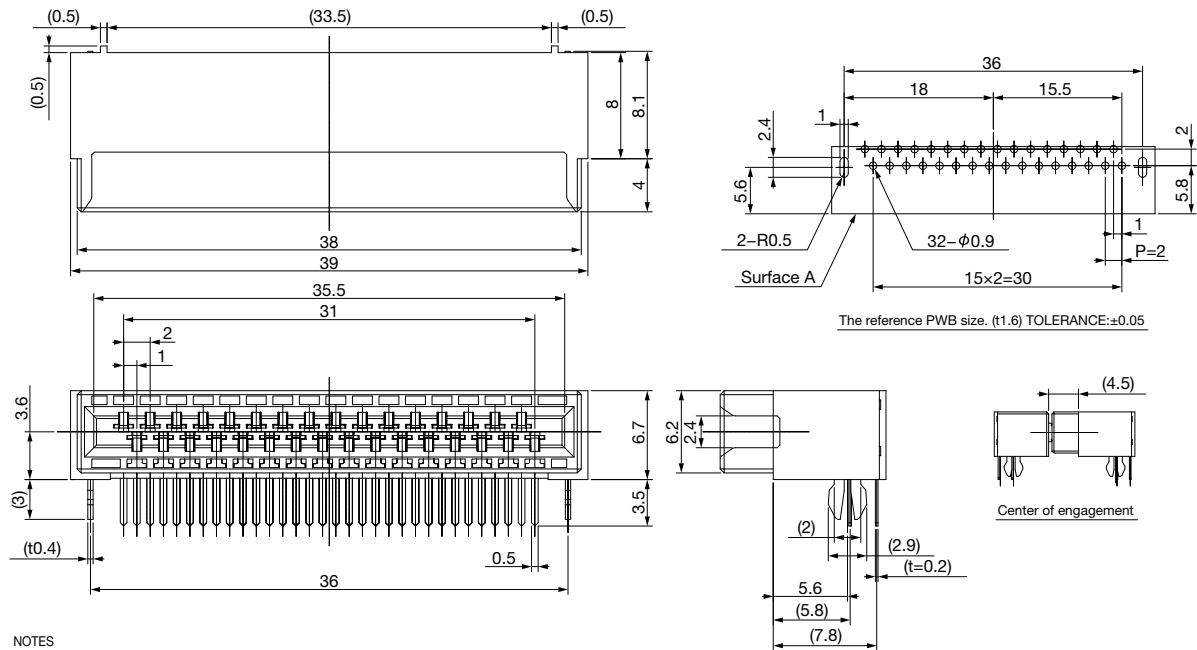

The reference PWB size, (t1.6) TOLERANCE:±0.05

- NOTES
- 1) This connector supports flow. (The reflow does not support.)
 - 2) Conformity PWB thickness : t=1.6mm, 1.2mm.